

THE TOWN OF STONY PLAIN

BY-LAW NO. 998

Inactive  
Bylaw 1031  
holds latest  
Amendment to  
Figure 8

BEING A BY-LAW IN THE TOWN OF STONY PLAIN IN THE PROVINCE  
OF ALBERTA TO AMEND BY-LAW NO. 865, THE STONY PLAIN  
SOUTH EAST AREA STRUCTURE PLAN

---

WHEREAS in accordance with Section 68(1) of the Planning Act, being Chapter P-9 of the Revised Statutes of Alberta, 1980, the Council of the Town of Stony Plain in the Province of Alberta has passed the Stony Plain South East Area Structure Plan, By-Law No. 865; and

WHEREAS the Council of the Town of Stony Plain deems it to be in the public interest to amend the Stony Plain South East Area Structure Plan, By-Law No. 865;

NOW THEREFORE the Council of the Town of Stony Plain, duly assembled, hereby enacts as follows:

Section 5.2 Land Use Distribution

Revised Figure 8        -        Design Concept  
Revised Table 4        -        Land Use Distribution

As Per revised attachments.

Done and passed as a By-Law of the Town of Stony Plain in the Province of Alberta  
this        15th        day of        May        A.D. 1989.

Read a first time this    10th    day of        April        , A.D. 1989.

Read a second time this   15th    day of        May        , A.D. 1989.

Read a third time this    15th    day of        May        , A.D. 1989.

  
MAYOR REG R. KOTCH

  
RICHARD H. MAH  
SECRETARY-TREASURER

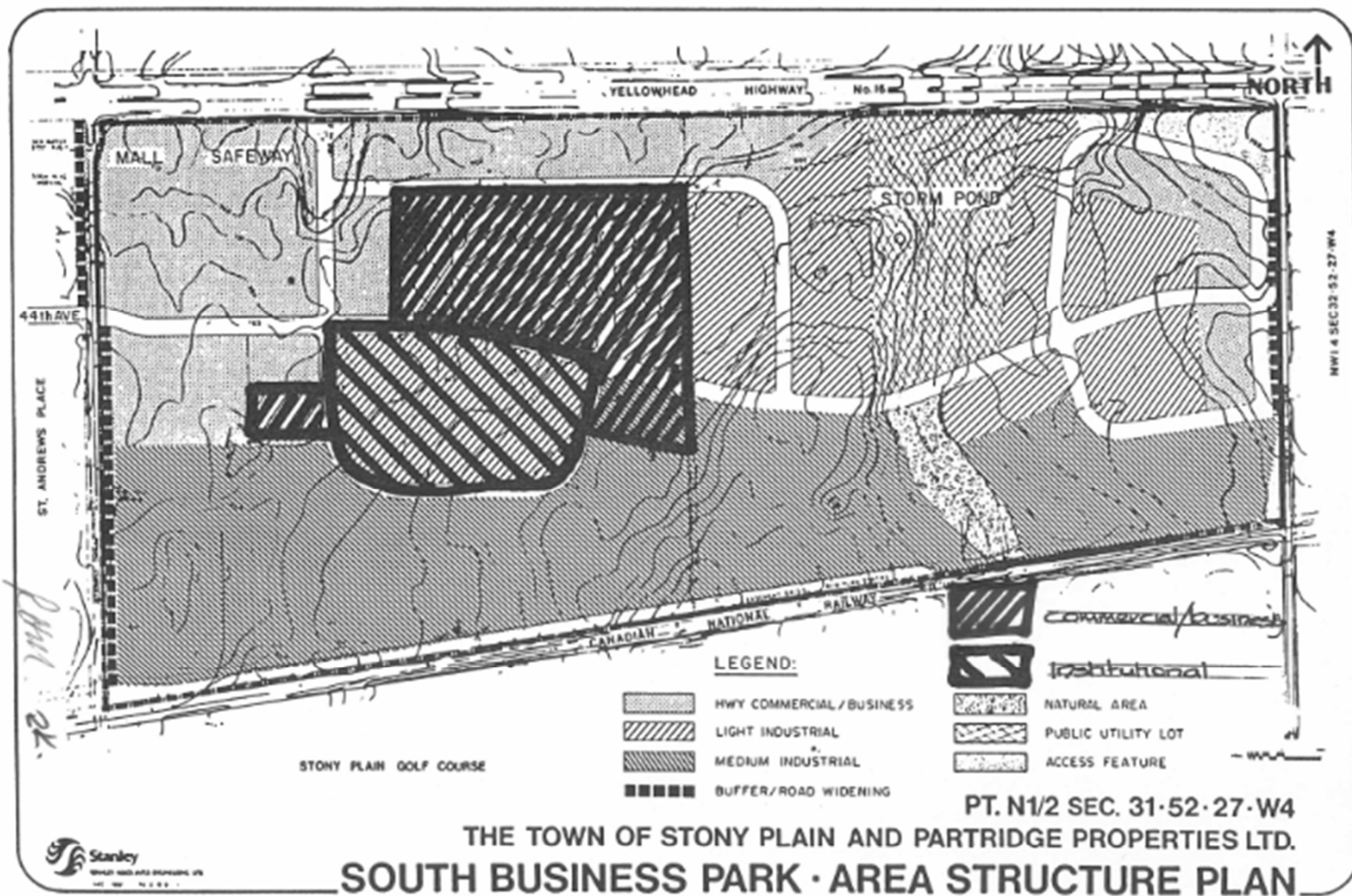

Land Use Concept fig. 6

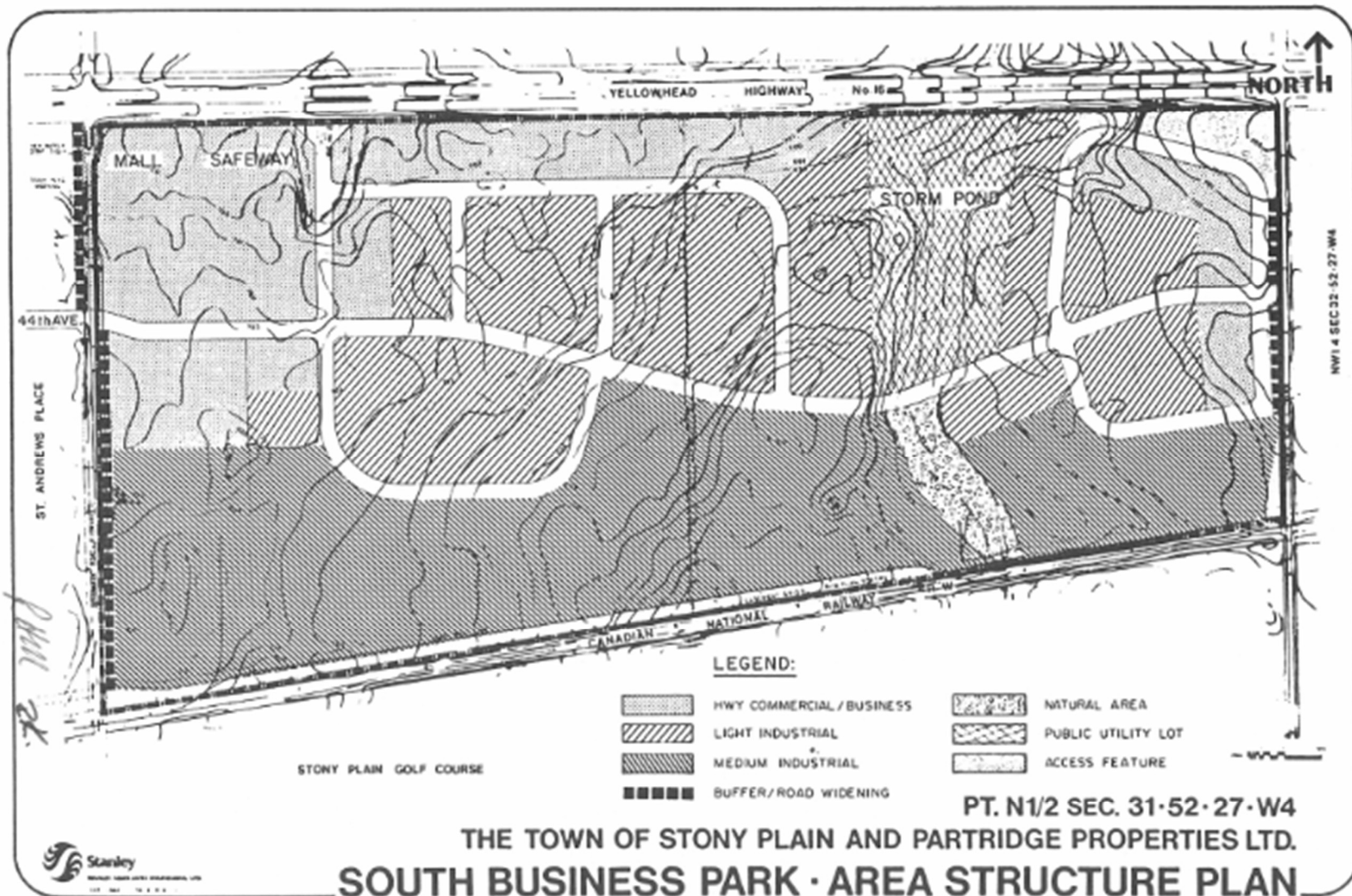

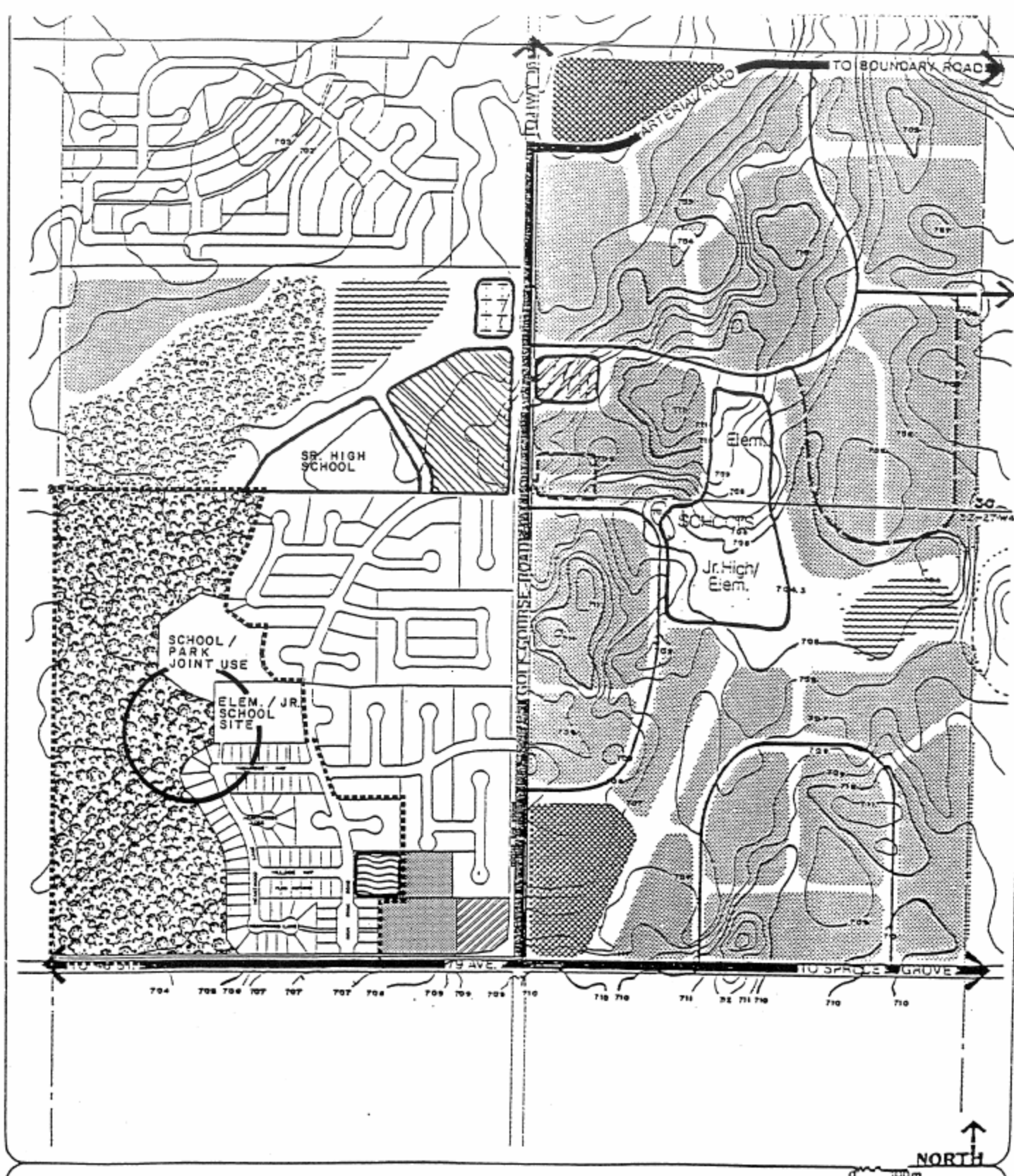

# SOUTHEAST STONY PLAIN AREA STRUCTURE PLAN - PROPOSED REVISION

- |  |                    |  |                             |
|--|--------------------|--|-----------------------------|
|  | SINGLE FAMILY DEV. |  | NEIGHBOURHOOD COMMERCIAL    |
|  | MEDIUM DENSITY     |  | ALTERNATE NEIGH. COMMERCIAL |
|  | HIGH DENSITY       |  | STORM WATER DETENTION POND  |
|  | CHURCH             |  | PRIVATE INSTITUTION         |
|  | NATURAL AREA       |  | WATER RESERVOIR             |
|  | SCHOOL             |  |                             |

OCTOBER, 1989

DESIGN CONCEPT

Fig. 8

*Handwritten signature/initials*