

# Town of Stony Plain

## LAND USE DISTRICTS MAP

Bylaw 2719/LUO/25

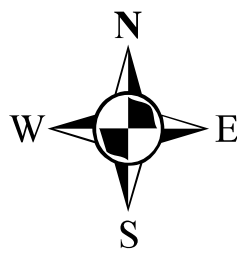
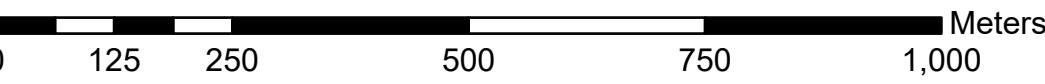

Map and documents made available to the public by the Town are not legally recorded maps, nor surveys and are not intended to be used as such. The maps and documents are created as part of a Geographic Information System (GIS) that compiles records, information, and data from various sources. The source data may contain errors or omissions. If errors or discrepancies are found please contact (780) 963-2151. The Town shall not be liable for any damages or claims that arise out of the user's access to, or use of the maps, documents and data provided. Parcel Data: Abta/LS For additional information please contact: GIS Coordinator, gis@stonyplain.com, (780) 963-2151

### Land Use Bylaw Districts

Residential Districts	Employment Districts	Other Land Use Districts
R1 – Large Lot Detached Dwelling Residential District	C1 – Local Commercial District	P1 – Parks District
R2 – Detached Dwelling Residential District	C2 – General Commercial District	P2 – Community Services District
R3 – Residential Park District	C3 – Central Mixed Use District	P3 – Utility District
R4 – Mixed Form Residential District	M1 – Business Industrial District	FD – Future Development District
R5 – Small Lot Mixed-Form Residential District		
R6 – Comprehensively Planned Residential District		
R7 – Multi-Unit Building Residential District		
R8 – High Density Residential District		

### Map Elements

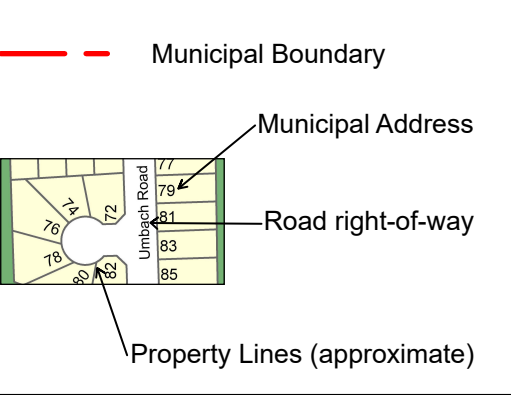

August 2025

### Consolidated Version

Amended by bylaws:

2721/LUO/25, June 23, 2025

2726/LUO/25, August 25, 2025